



step-by-step

# DRAW KAWAII

## CUTE FOOD



by  
ISOBEL  
LUNDIE



**DRAW KAWAII**  
**CUTE**  
**FOOD**

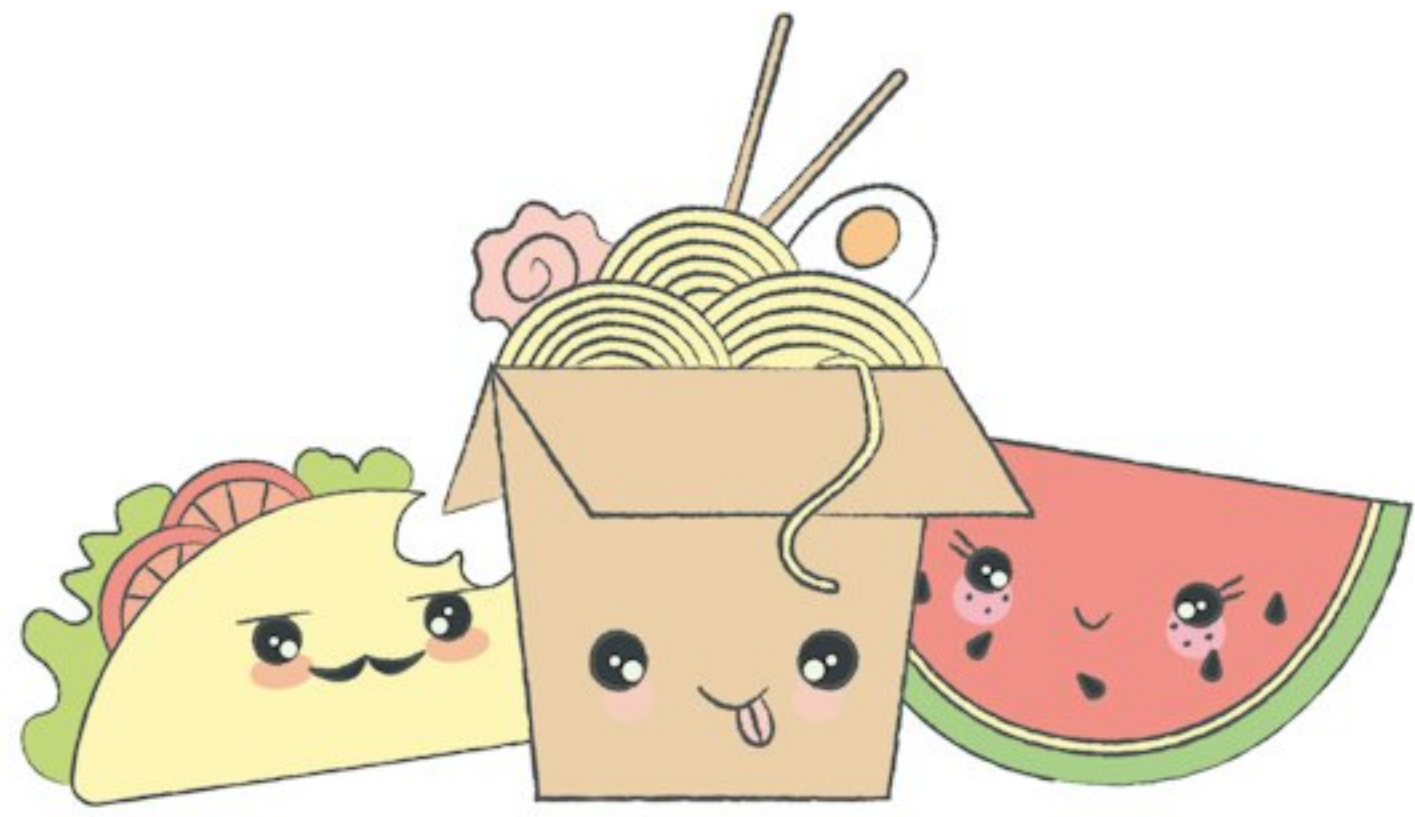

First published in the UK in 2022  
by The Salariya Book Company Ltd  
This edition published in the UK in 2024 by Hatch Press,  
an imprint of Bonnier Books UK  
4th Floor, Victoria House  
Bloomsbury Square, London WC1B 4DA  
Owned by Bonnier Books  
Sveavagen 56, Stockholm, Sweden  
www.bonnierbooks.co.uk

Copyright © 2024 by Hatch Press

1 3 5 7 9 10 8 6 4 2

All rights reserved

ISBN 978-1-80078-994-4

Printed in India





# contents

- 5. Introduction
- 6. Materials
- 8. Making everything cute
- 10. Adding features
- 12. Expressions
- 13. Practising expressions
- 14. Now it's your turn
- 16. Kawaii sushi
- 18. Kawaii pie
- 20. Kawaii juice
- 22. Kawaii ramen
- 24. Kawaii doughnut
- 26. Kawaii avocado
- 28. Kawaii taco
- 30. Kawaii ice cream
- 32. Kawaii watermelon slice
- 34. Kawaii burger
- 36. Kawaii pancakes
- 38. Kawaii peas in a pod
- 40. Kawaii hotdog
- 42. Kawaii candy floss
- 44. Kawaii broccoli
- 46. Kawaii potato
- 48. Kawaii cupcake
- 50. Kawaii pear
- 52. Kawaii coffee
- 54. Kawaii popcorn
- 56. Kawaii egg
- 58. Kawaii bread
- 60. Kawaii sweets
- 62. Kawaii milk
- 64. Glossary and index

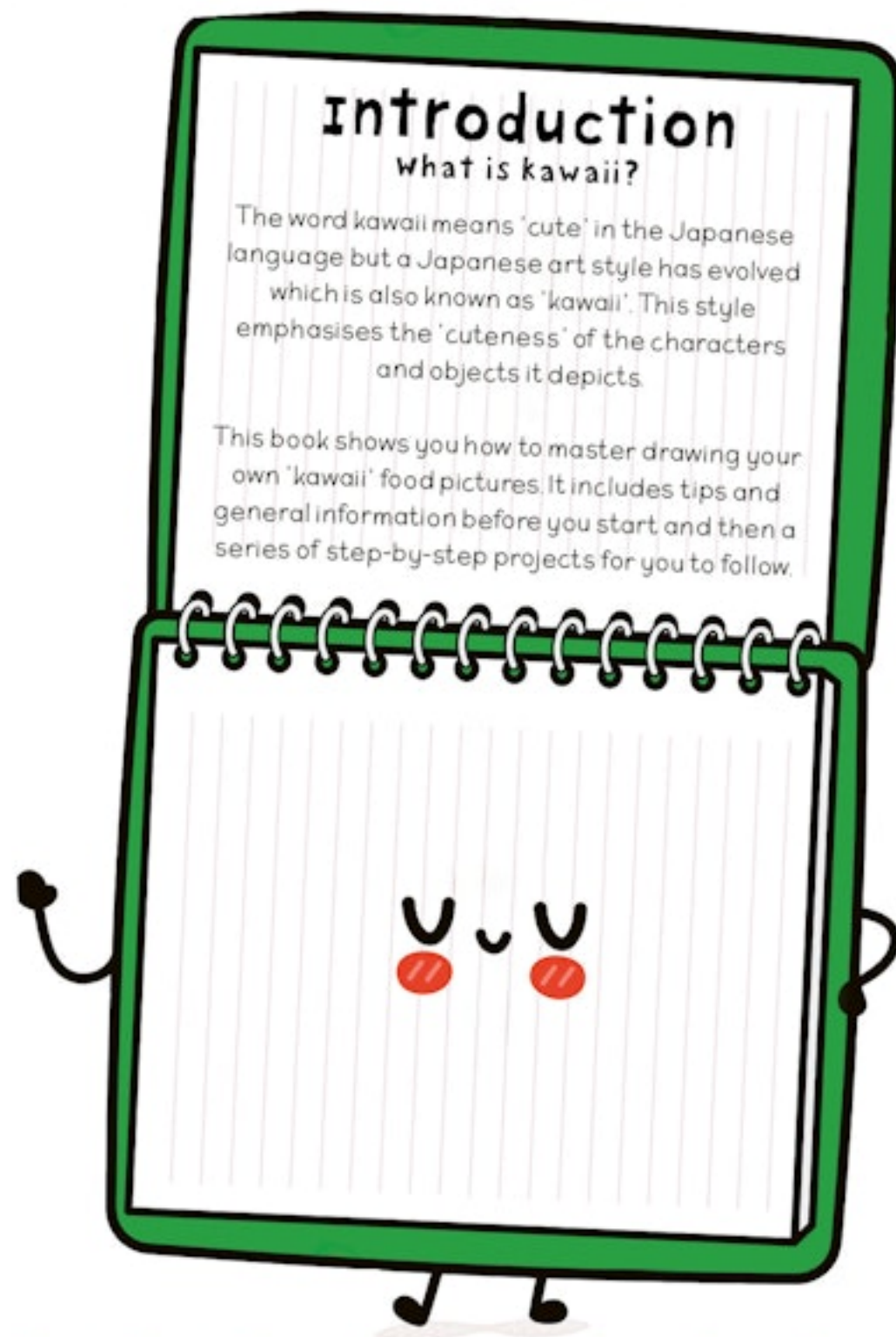



# Materials



## Pencil

Drawing with an HB pencil makes it easier to erase any unwanted lines.

## Materials

The ideas in this book can be used in different ways and with different materials. Here are some suggestions.

## coloured paper

Try drawing kawaii food on coloured paper!



## coloured pencils

Coloured pencils are ideal for shading. See this watermelon drawing.

## Labels

Make your own kawaii labels for your presents.



## stickers

Draw onto stickers to make cute drawings for your friends!



## ink

Use a small brush to make cute inky paintings!



## sketchbook

Use a sketchbook so you keep all your drawings together.





# Making everything cute

## Soften shapes

Rounding off the points of a triangle softens its shape. Try softening the edges of shapes when drawing your kawaii characters.

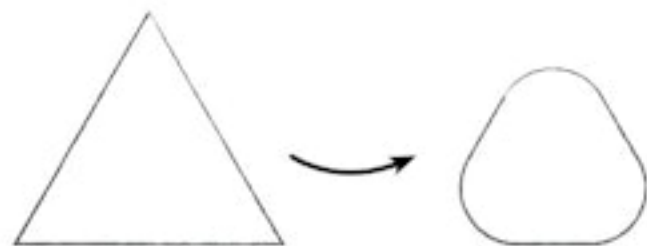

## Simplify drawings

Make your drawing cuter by simplifying it down to its key features. This way you can make almost anything cute!

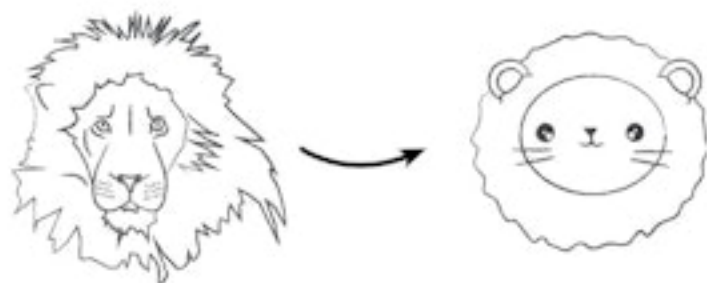

## Proportions

The kawaii body should be proportioned as shown. A large head, with a short body and short legs.

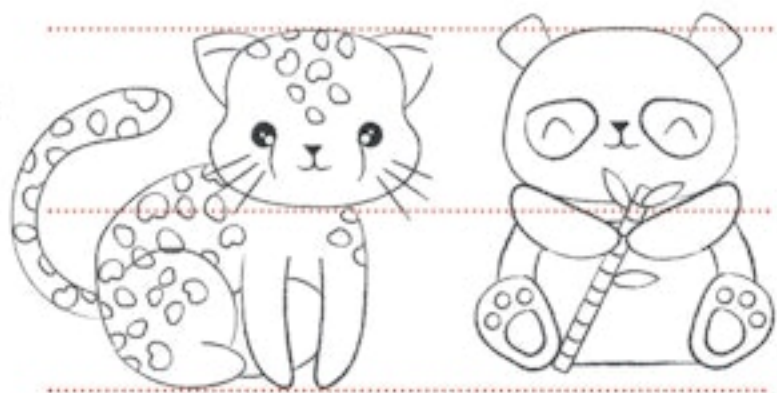

## Add a cute face

You can make almost anything cute by drawing an appealing cartoon face on it.

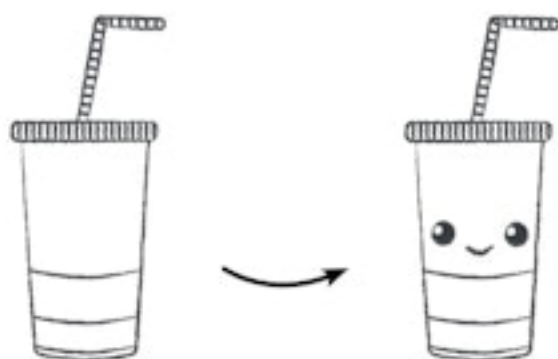

## colours to soften

Pastel colours are cuter. Try using soft pastel colours to make your characters cuter.

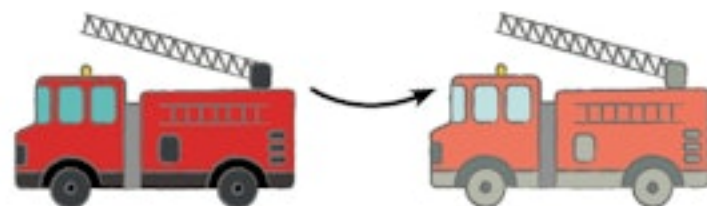

## Motion lines

Adding motion lines in this way is a simple and effective way to convey movement in a drawing.

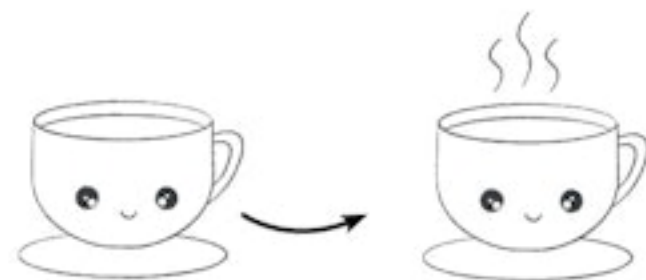

# Adding extras

## cute accessories

Add adorable accessories to your characters.

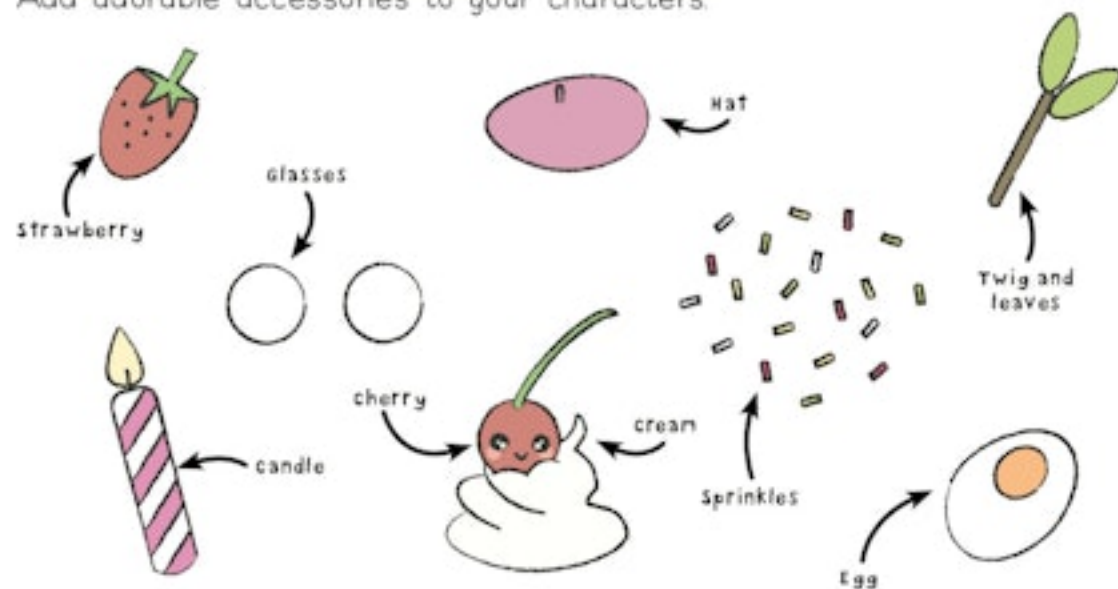

## cute utensils

Don't forget that utensils help to bring a character to life!

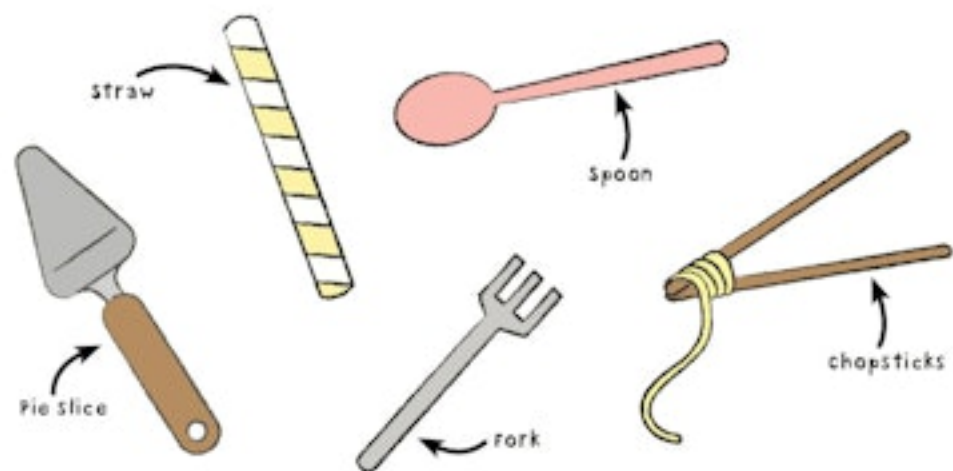

## drawing practice

Foods have all manner of distinguishing features. You'll need to get to know them all in order to draw them.

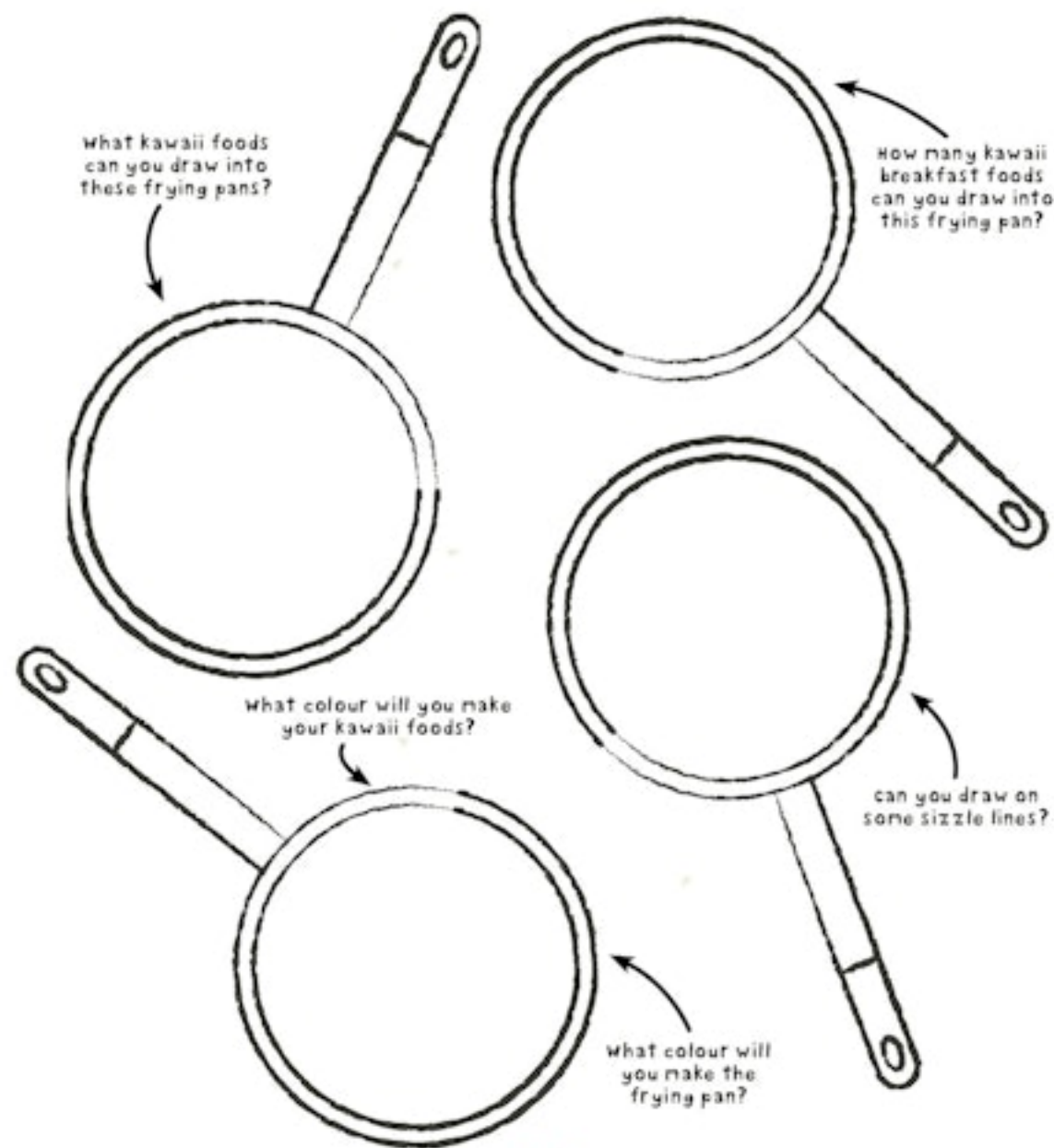



# Expressions

changing your character's expression adds personality.



**Happy**

Draw smiley 'n'-shaped eyes.



**Sad**

Draw downturned mouth and eyebrows.



**Angry**

Draw scrunched eyes.



**confused**

Draw one eyebrow raised.



**scared**

Raise both eyebrows.



**Excited**

Draw a wider mouth.



**Silly**

Draw in a floppy tongue.



**Tired**

Draw sleepy eyes.



**Embarrassed**

Draw a pursed mouth.

# Practising expressions

Why not try adding some of these expressions to make milkshake faces?

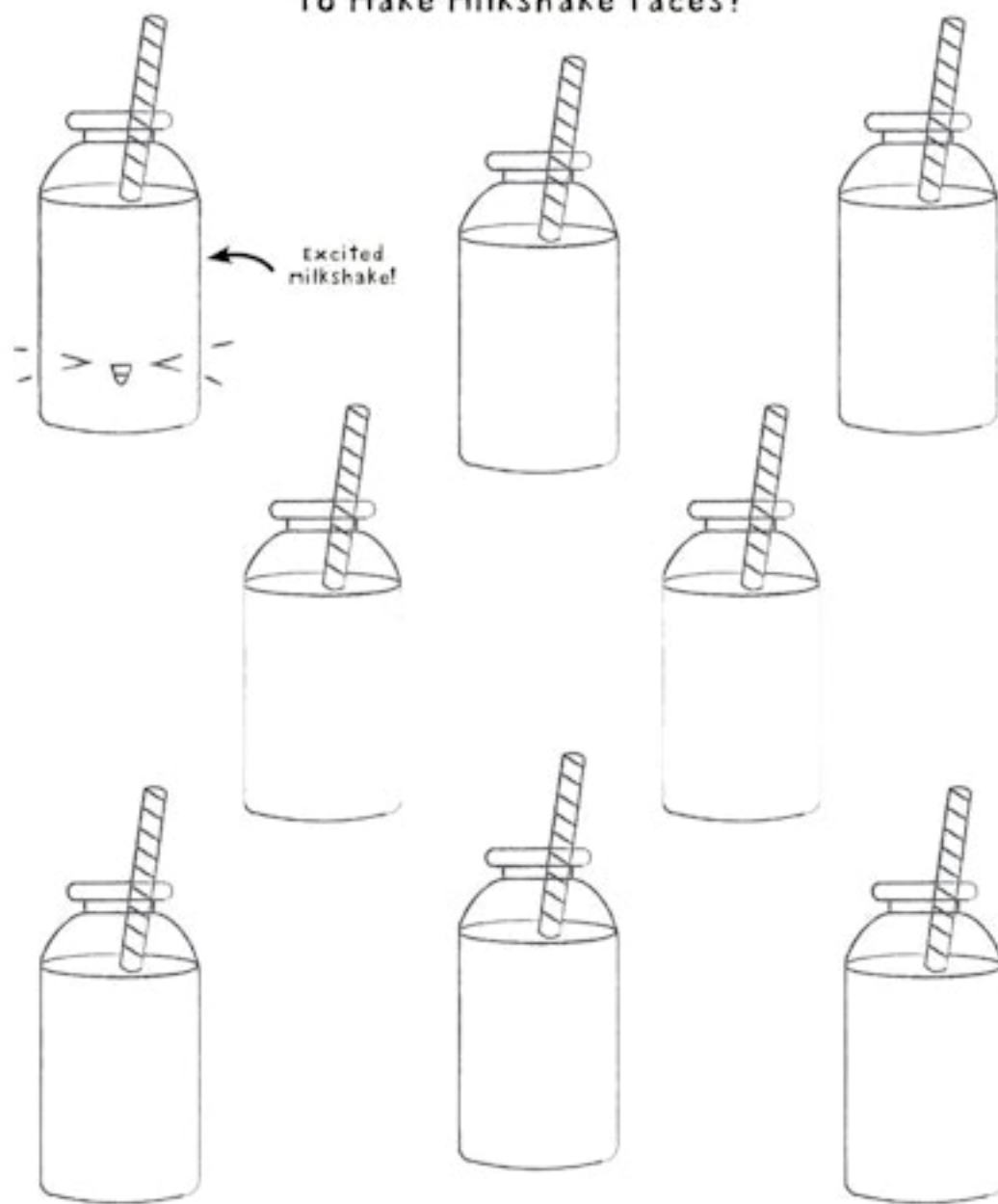



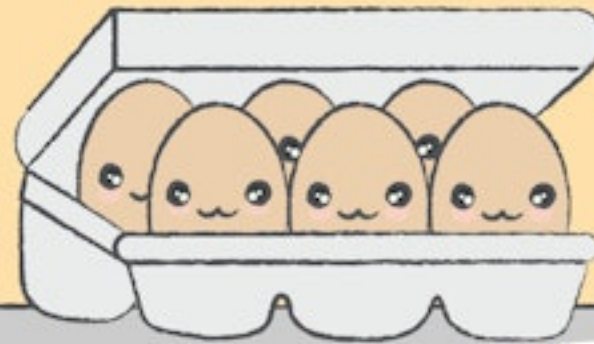
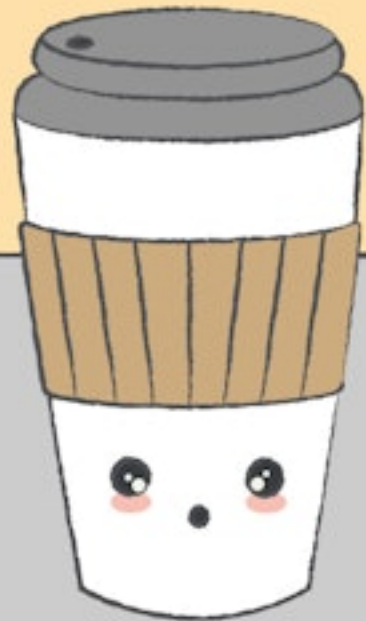

Now it's  
your turn

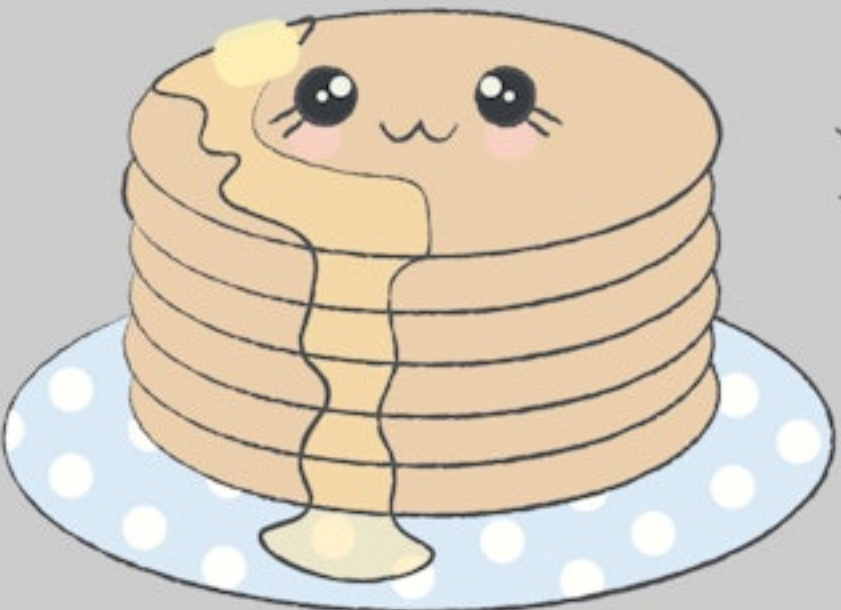

# Kawaii sushi

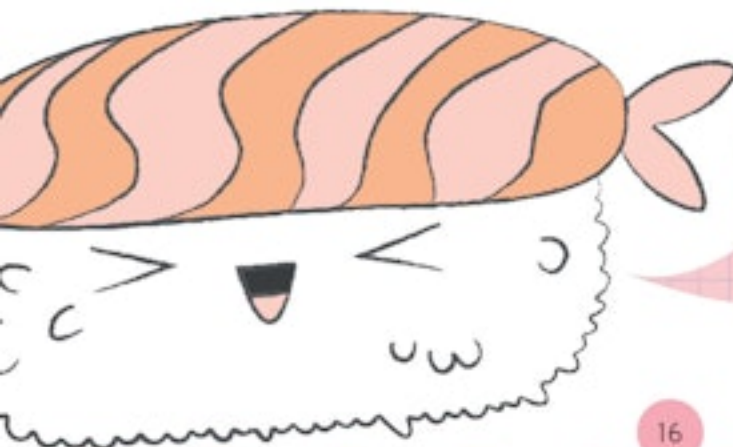
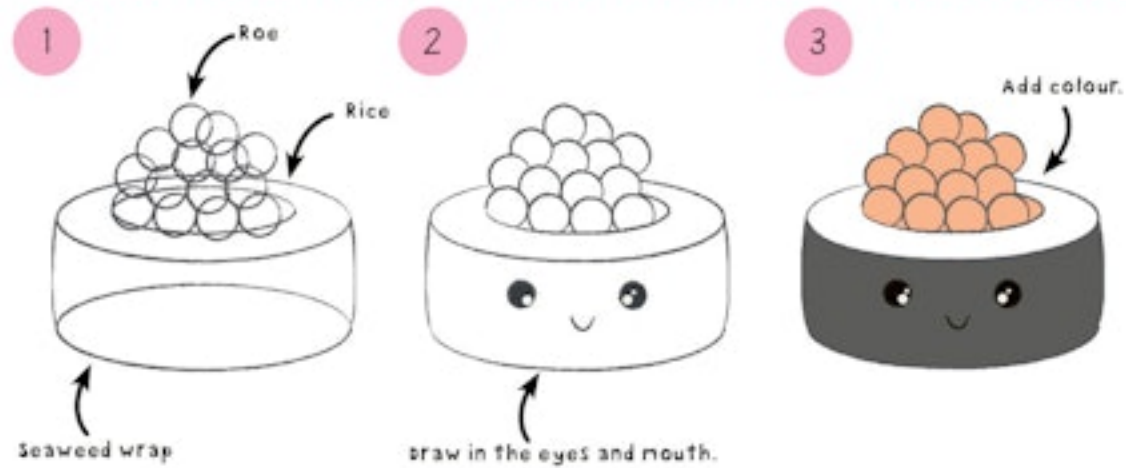
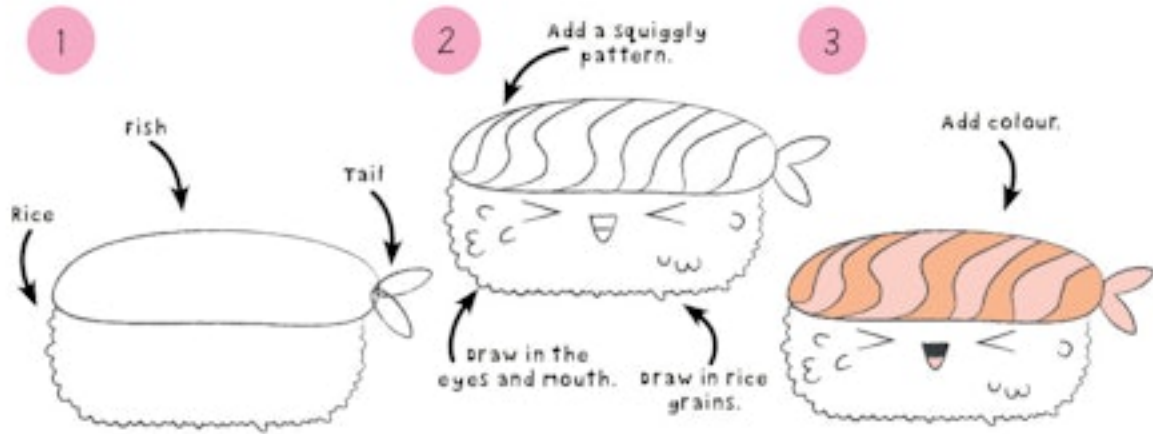

Why not draw your kawaii sushi being prepared in a sushi bar?

draw your own kawaii sushi.





# Kawaii pie

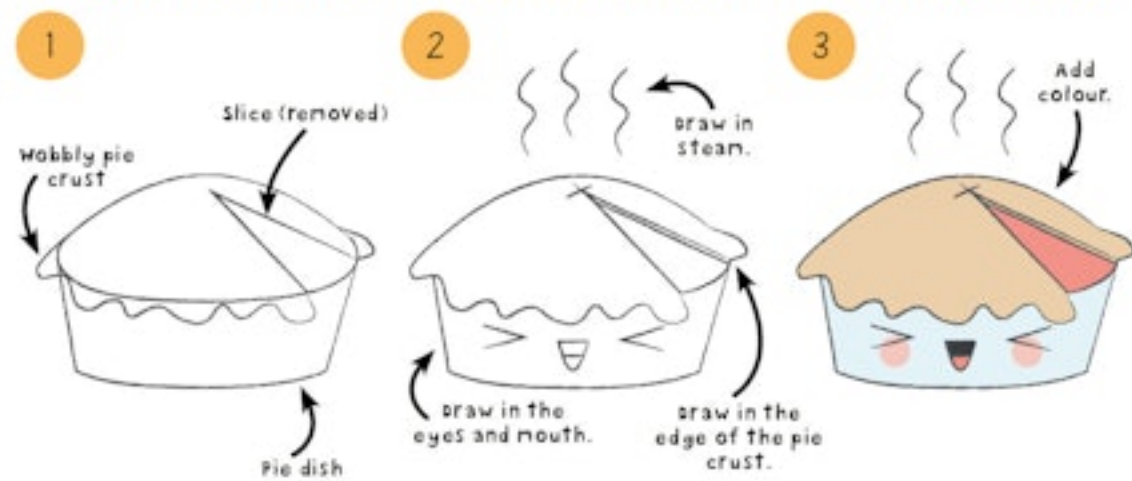
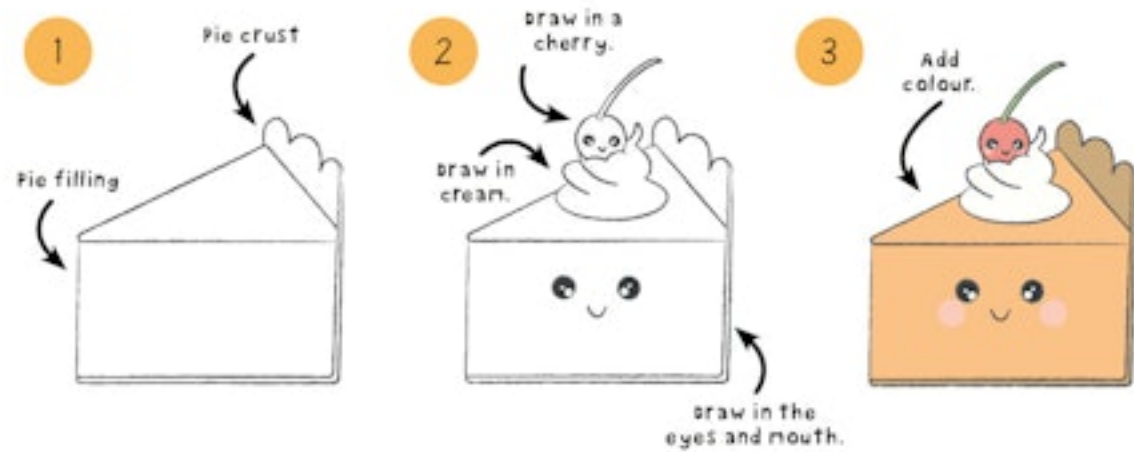

Why not draw your kawaii pie cooling on a windowsill?

18



draw your own kawaii pie.



19

# Kawaii juice

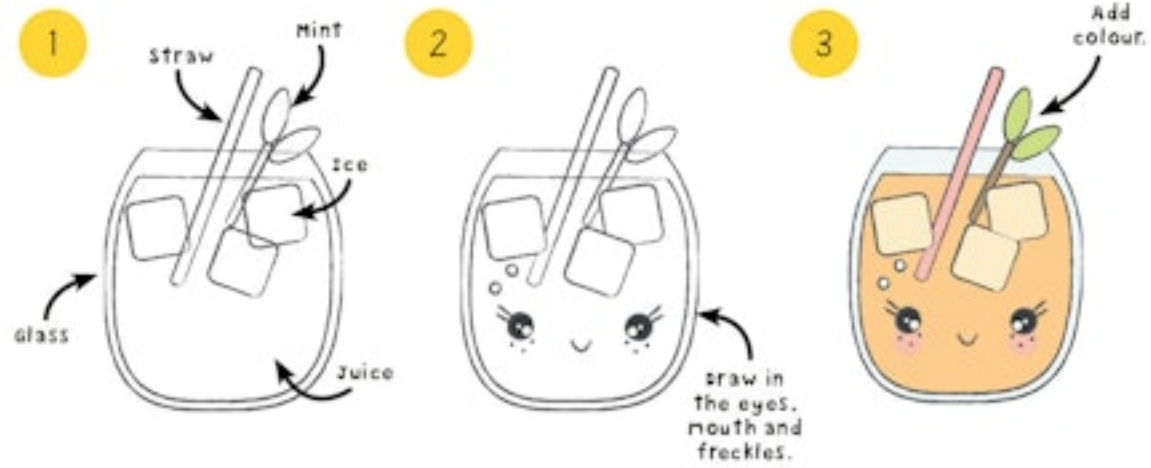

Draw your own kawaii juice.



Why not draw a selection of kawaii drinks with different fruits and expressions?





# Kawaii ramen

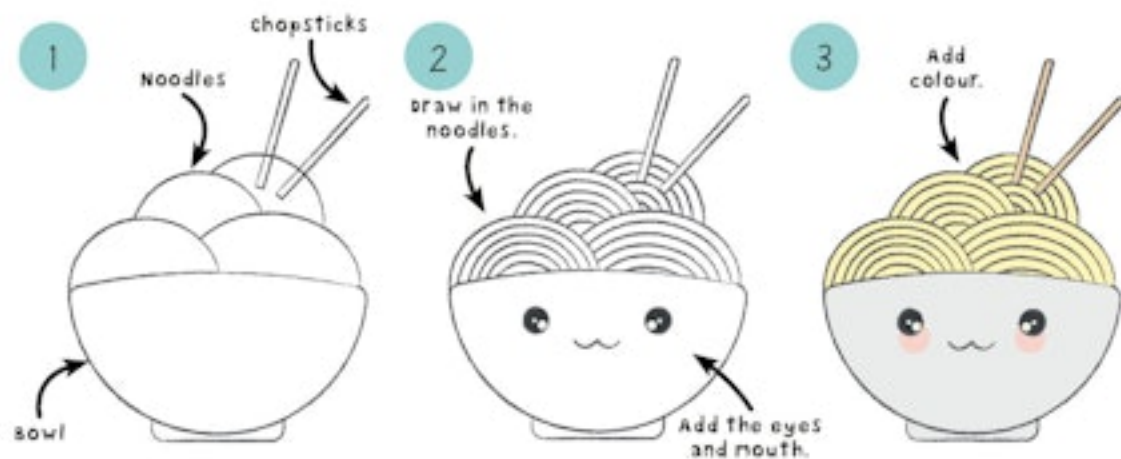

Draw your own kawaii ramen.

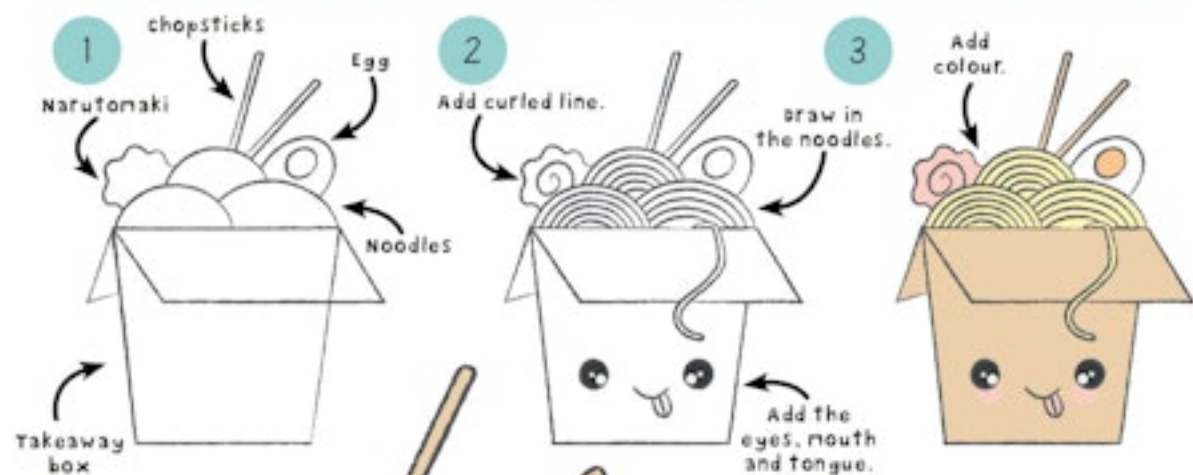

Why not draw a kawaii person eating your kawaii ramen?

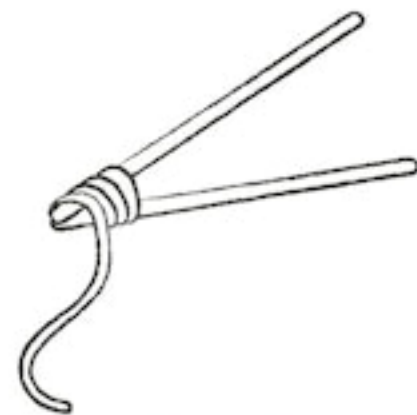

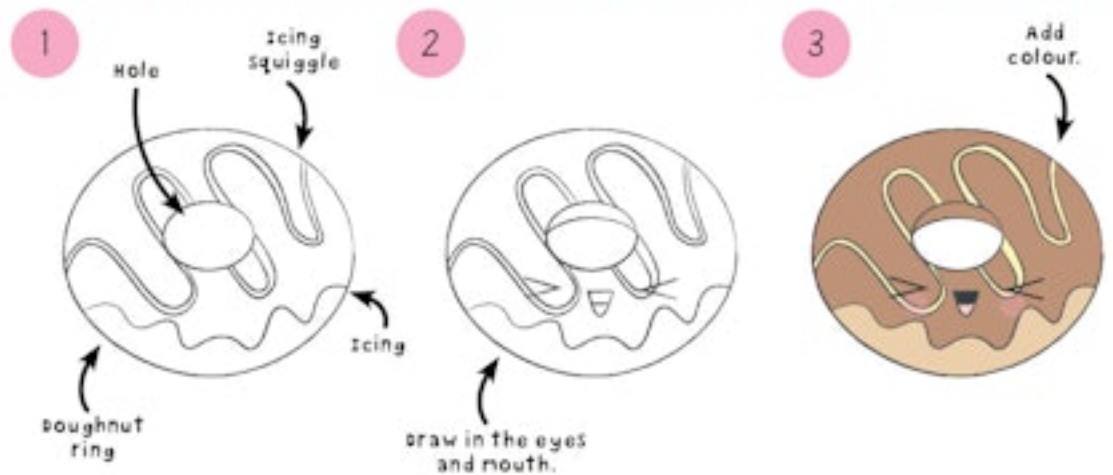
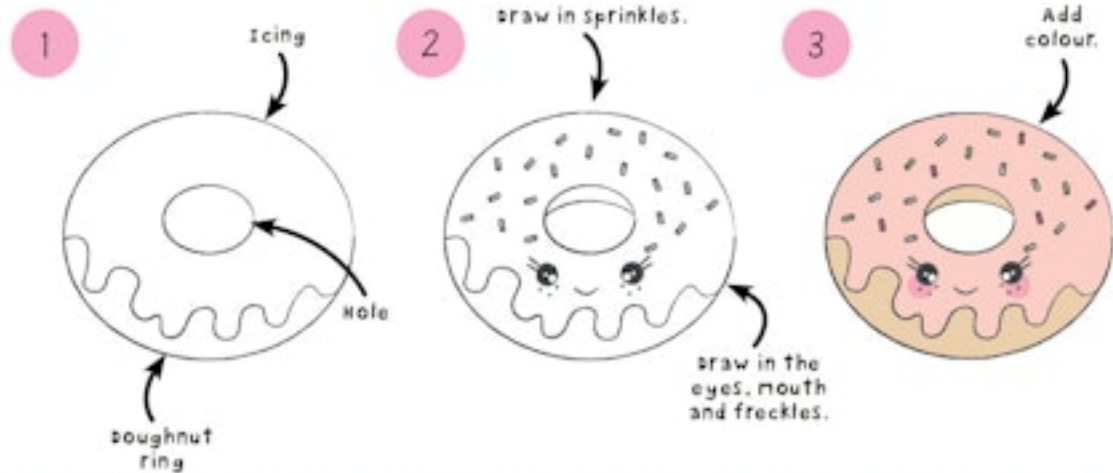

Why not draw your kawaii doughnuts on display in an American diner?

# Kawaii doughnut

Draw your own kawaii doughnut.





# Kawaii avocado

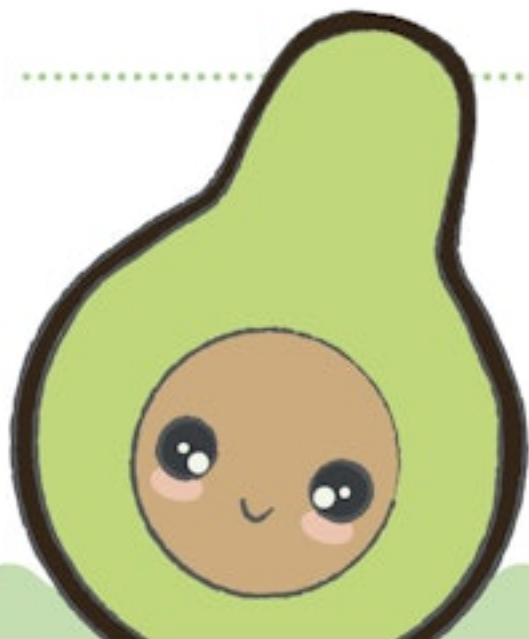
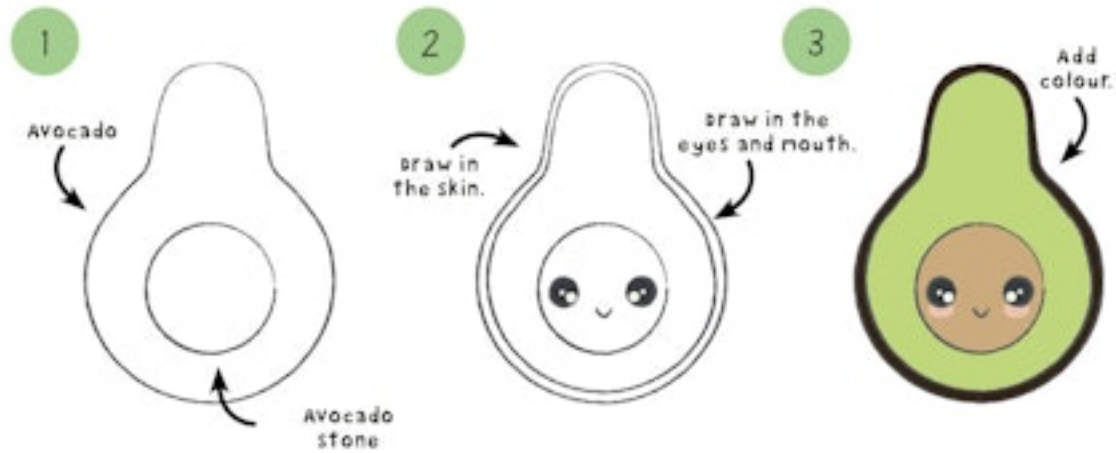

26

Why not draw your kawaii avocado in a basket outside a greengrocer's shop?

draw your own kawaii avocado.



27

# Kawaii taco

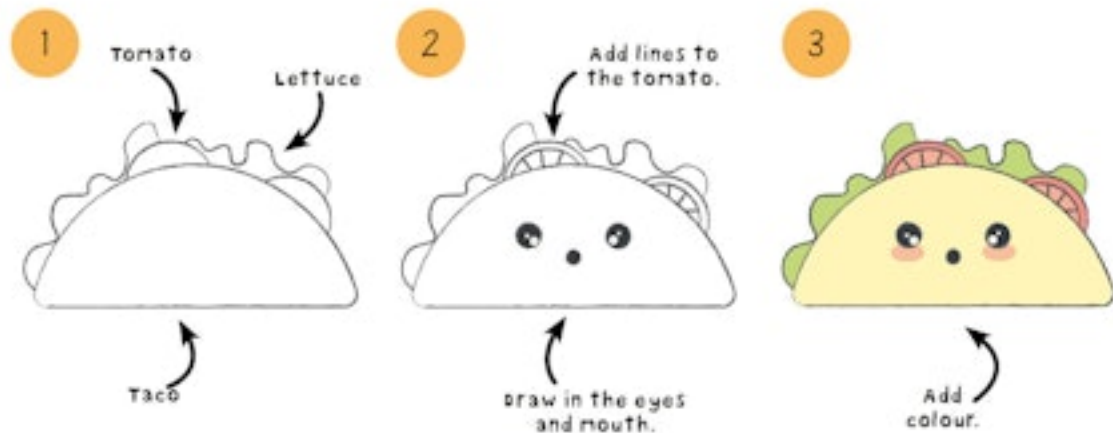

Why not draw your kawaii taco on a restaurant plate?



draw your own kawaii taco.

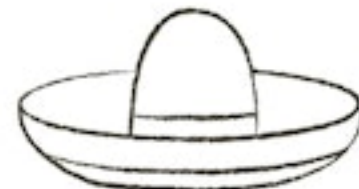



# Kawaii ice cream



Draw your own kawaii ice cream.

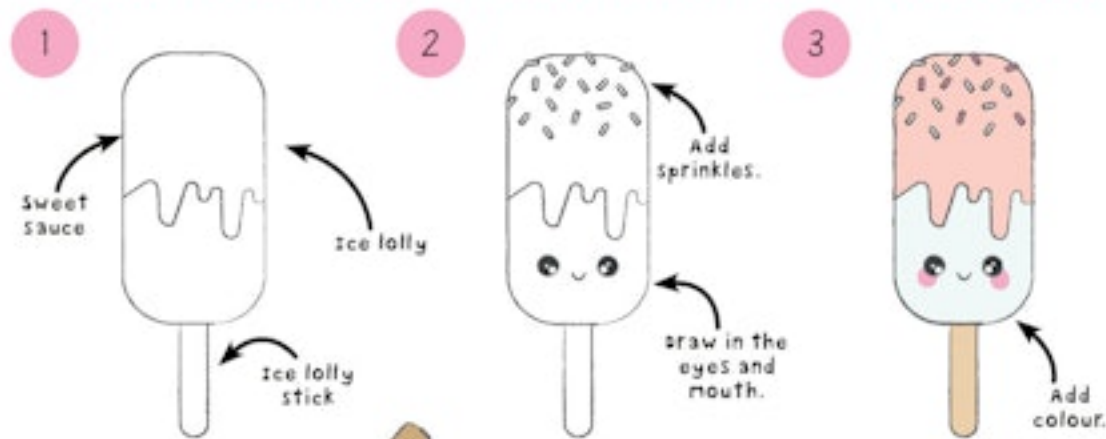

Why not draw a kawaii person eating your kawaii ice cream at the beach?



# Kawaii watermelon slice

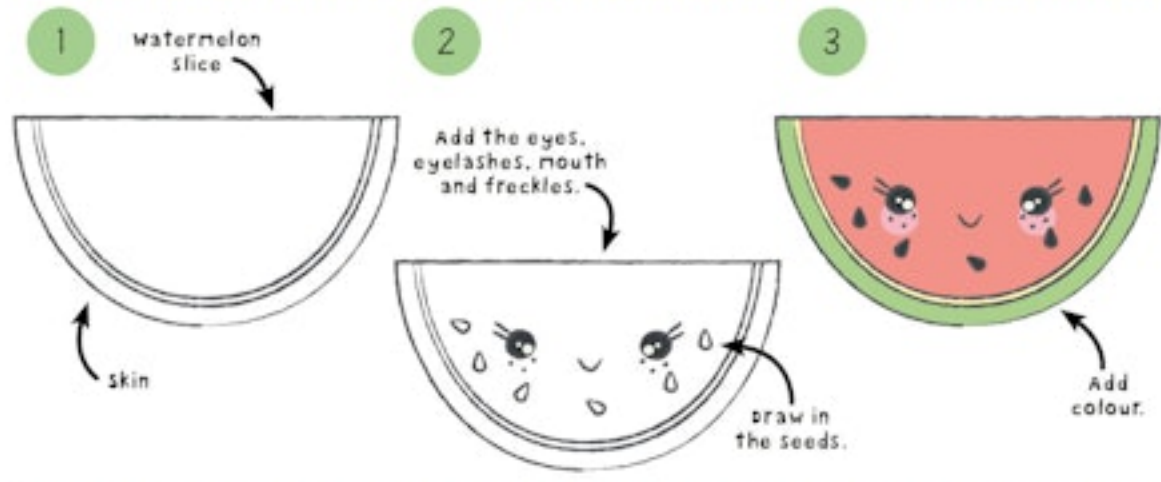
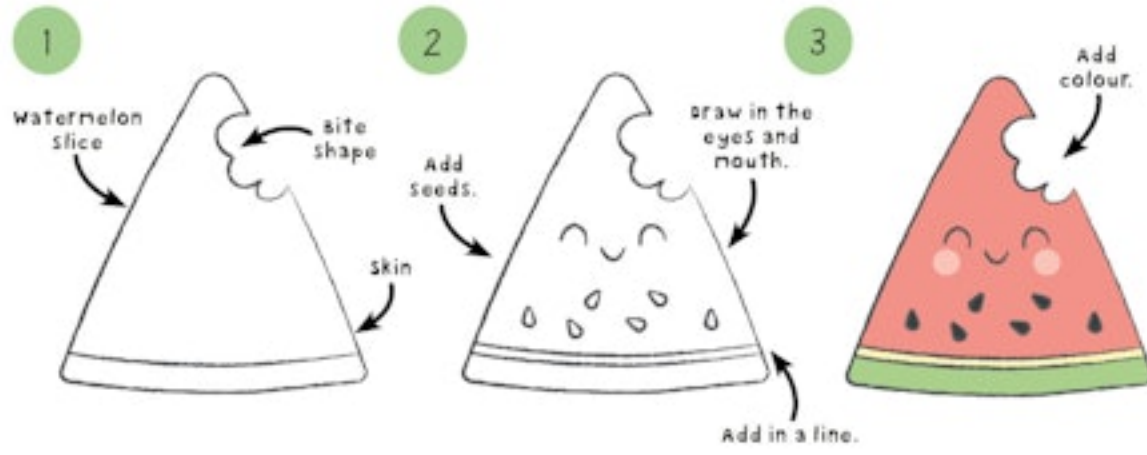

Why not draw a kawaii character eating a slice of your kawaii watermelon on a hot summer day?

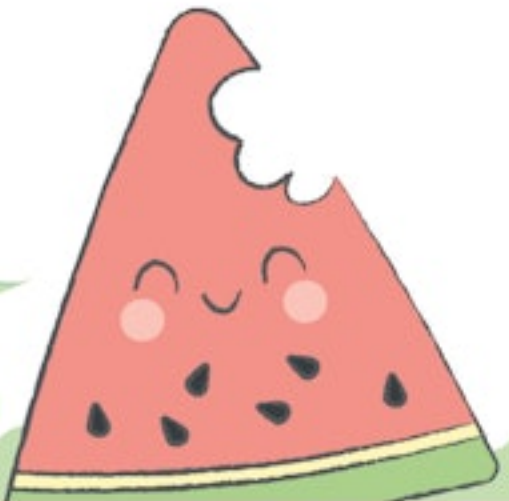

draw your own kawaii watermelon slice.





# Kawaii burger

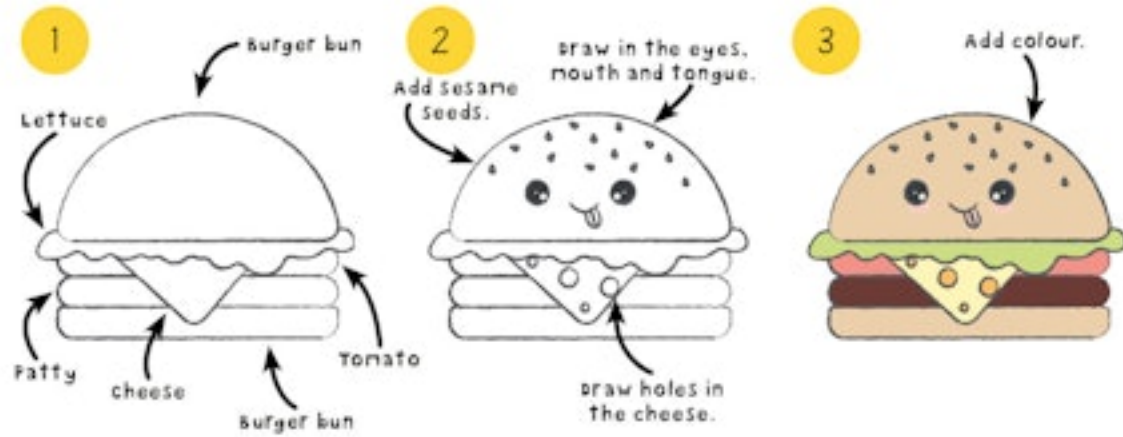

draw your own kawaii burger.

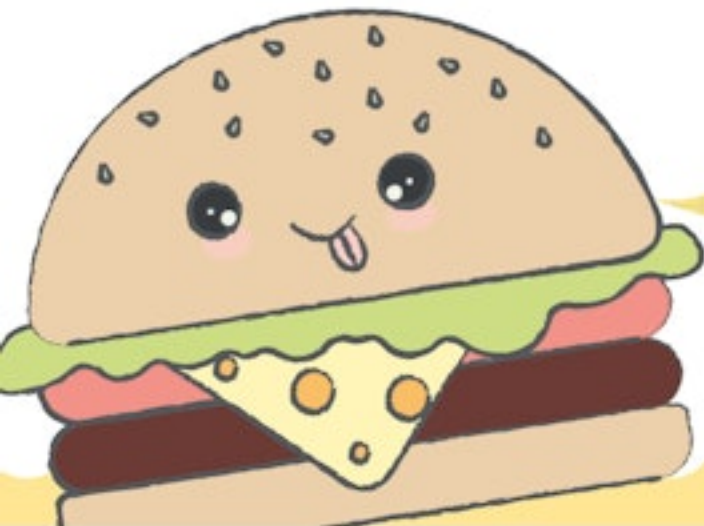
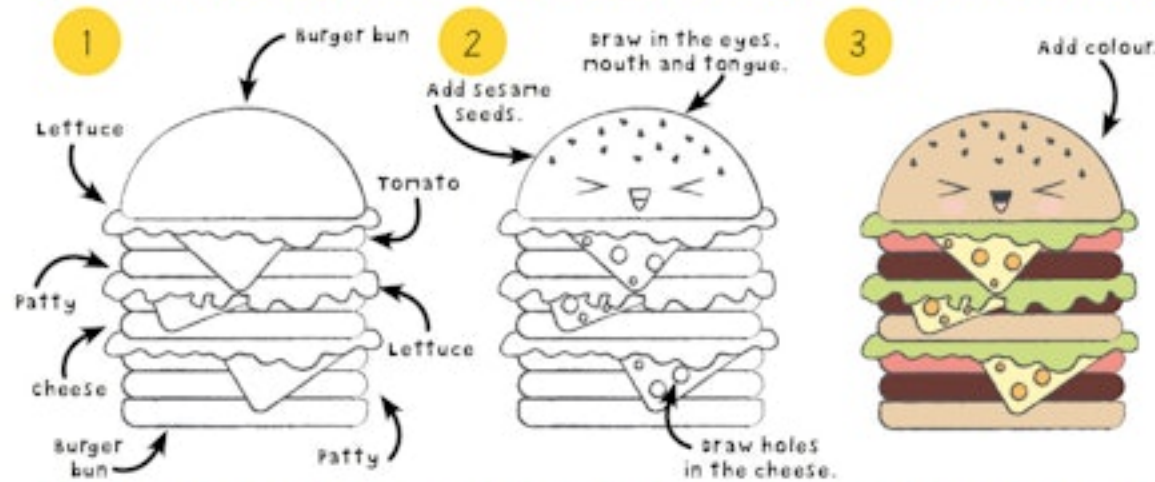

Why not draw your kawaii burger with some kawaii fries and a kawaii milkshake?



# Kawaii pancakes

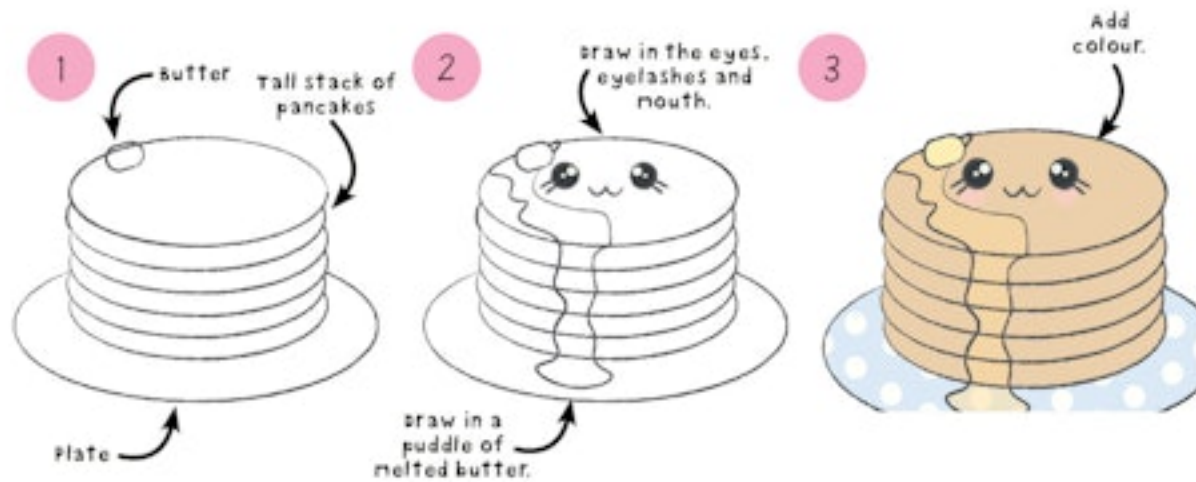

Why not draw your plate of kawaii pancakes on a table, beside a glass of kawaii orange juice?



draw your own kawaii pancakes.





# Kawaii peas in a pod

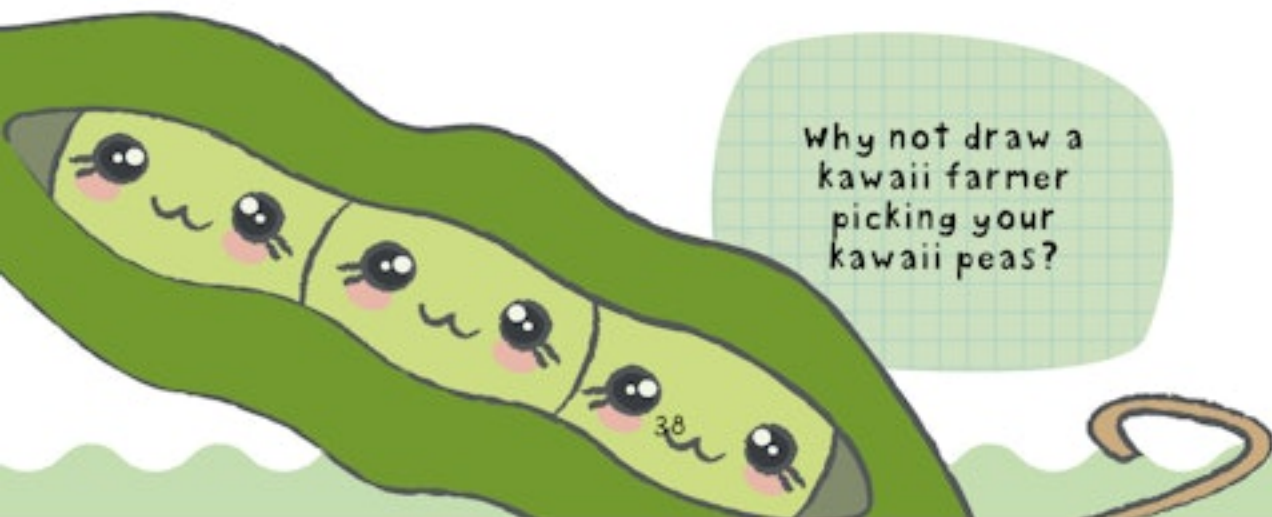
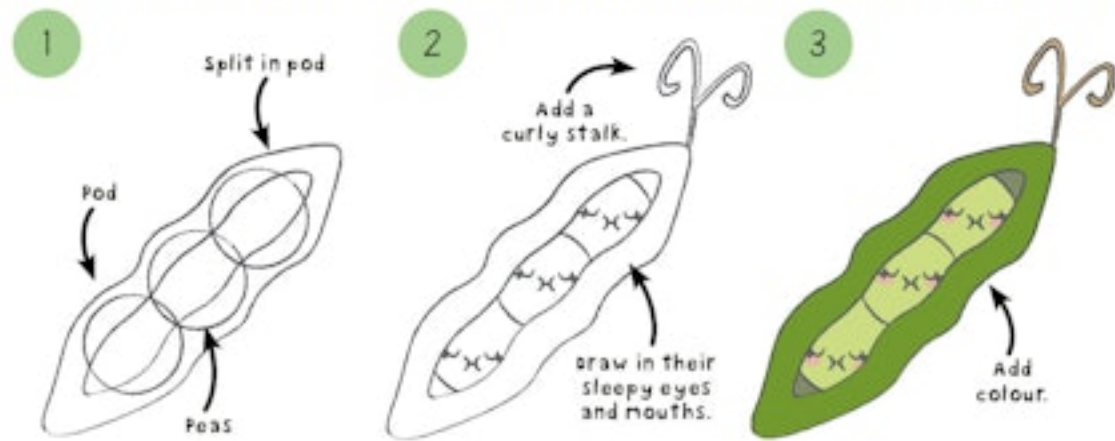
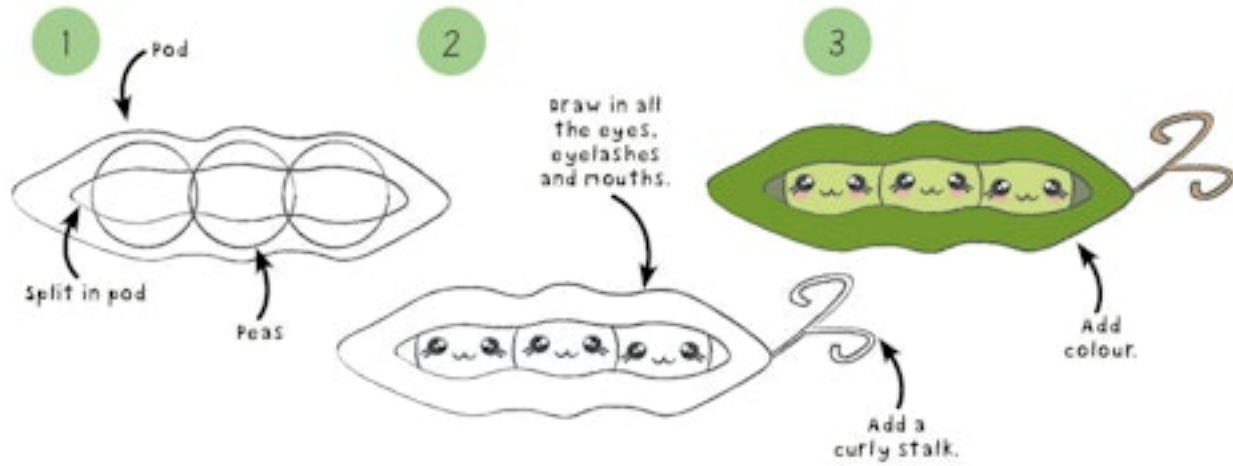

Draw your own kawaii peas in a pod.



# Kawaii hotdog

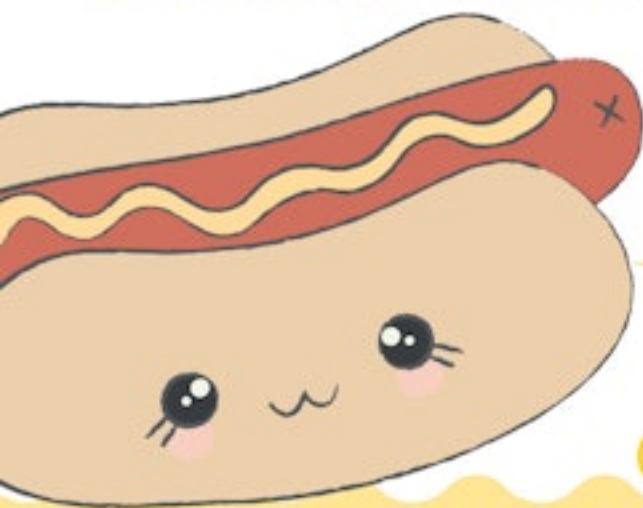
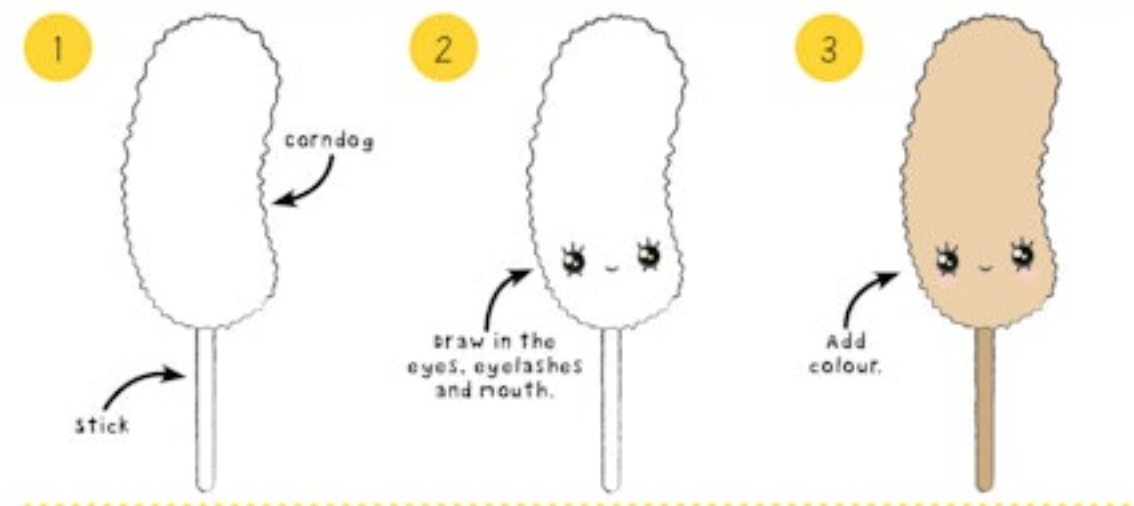
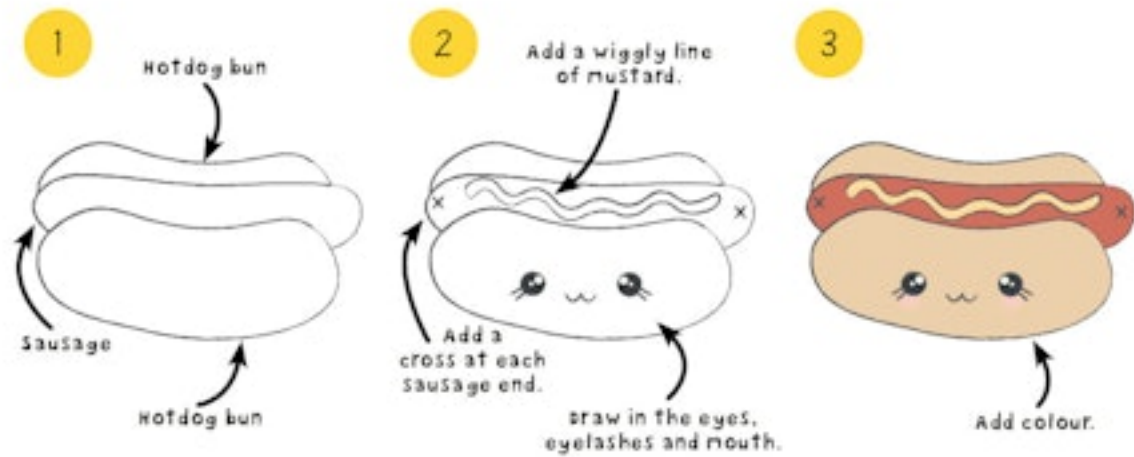

Why not draw a kawaii character holding a kawaii hotdog at a football match?

Draw your own kawaii hotdog.

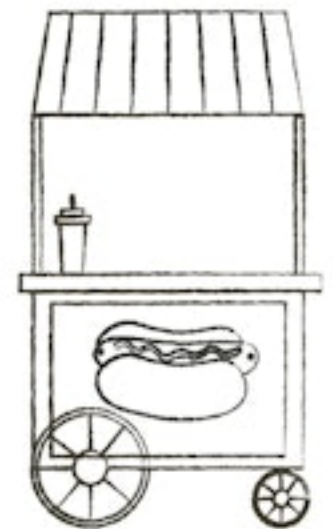



# Kawaii candyfloss

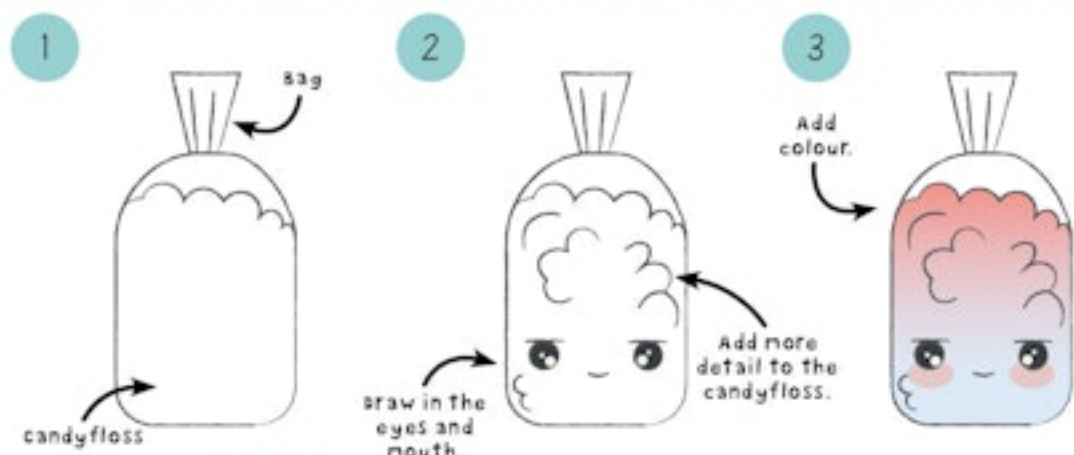
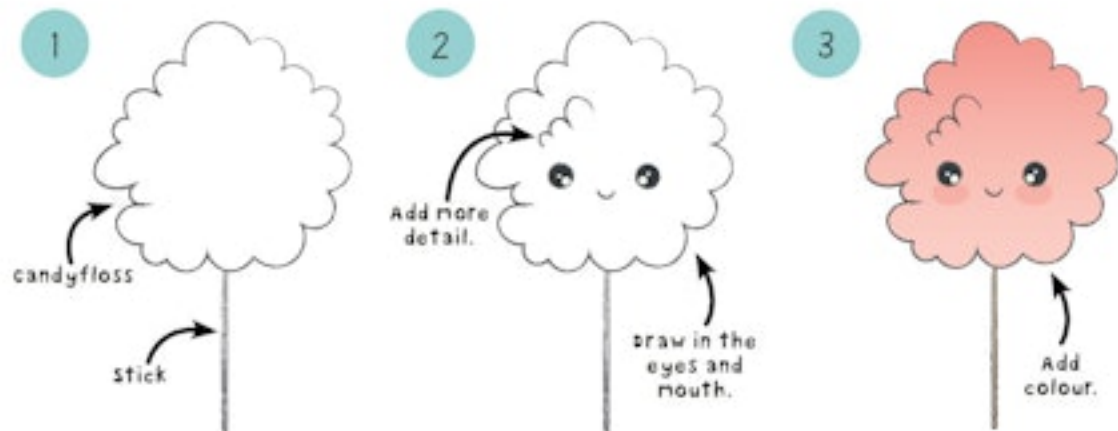

42

Why not draw your kawaii candyfloss being sold at a funfair?

draw your own kawaii candyfloss.

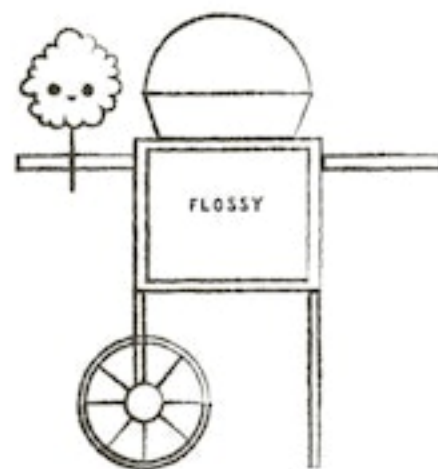

43

# Kawaii broccoli

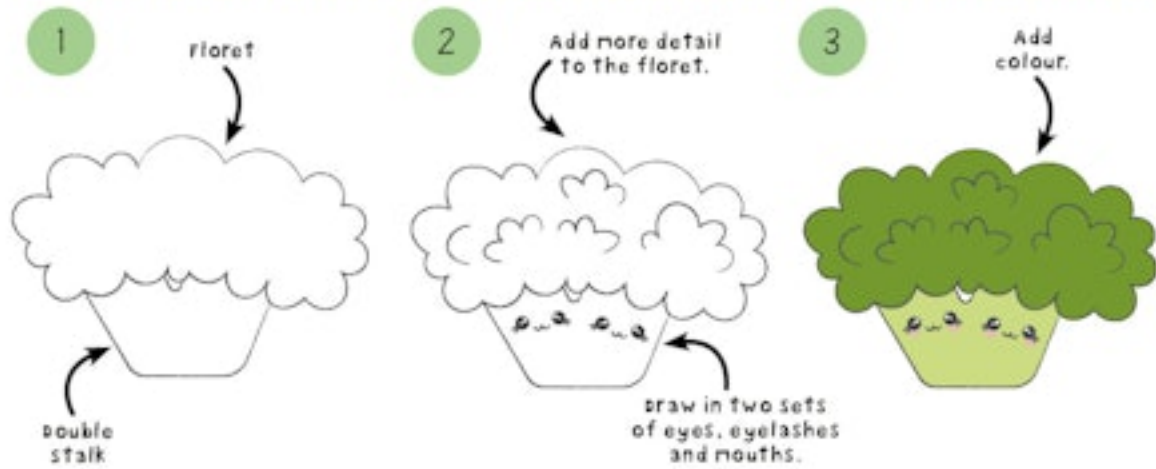
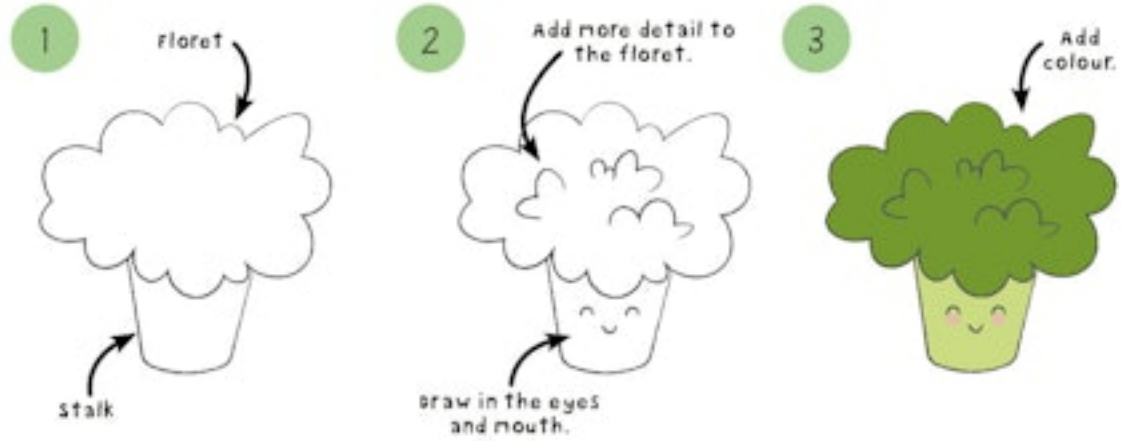

Why not draw your kawaii broccoli on a dinner plate?

draw your own kawaii broccoli.

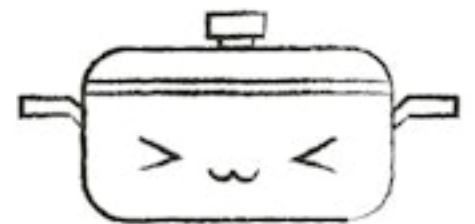



# Kawaii potato

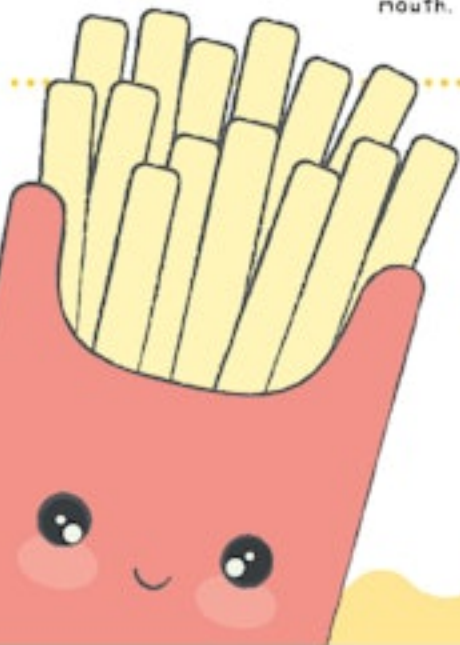
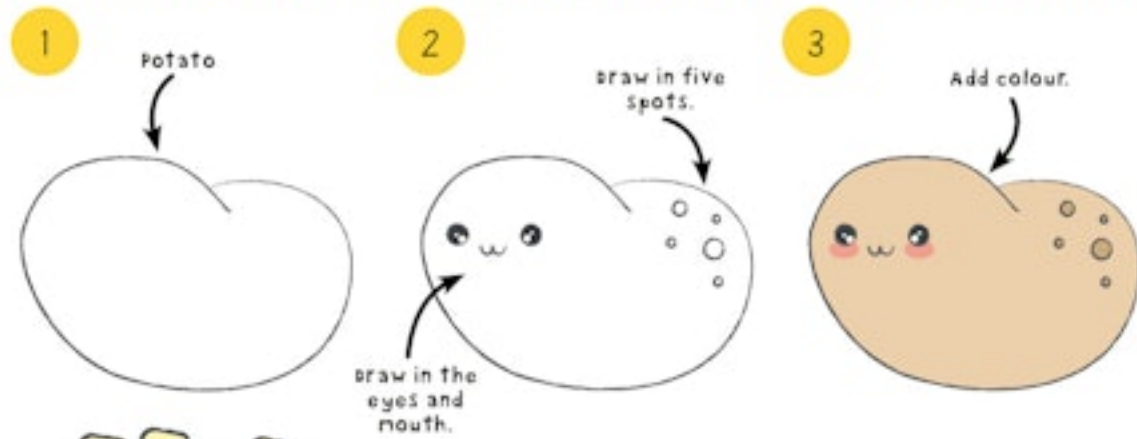
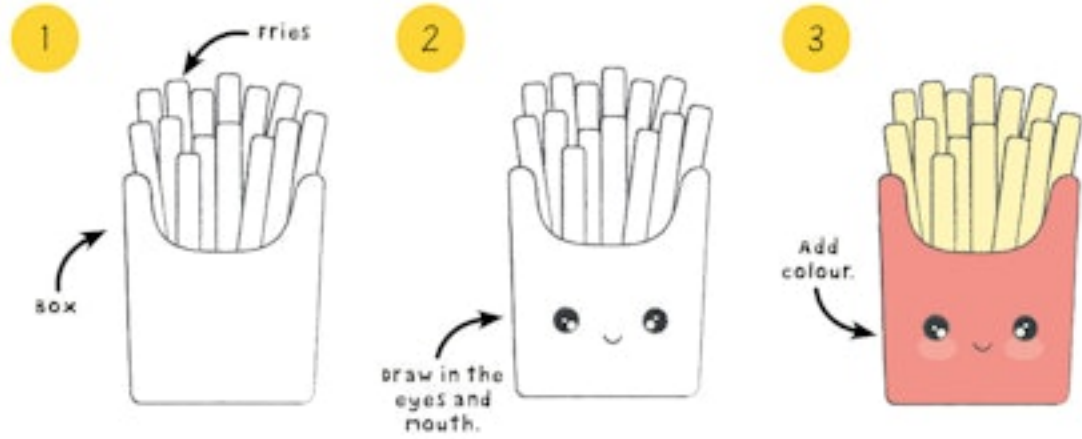

Why not draw your kawaii fries with a kawaii hotdog?

draw your own kawaii potatoes.

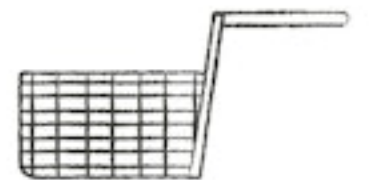

# Kawaii cupcake



Why not draw a plateful of kawaii cupcakes?

draw your own kawaii cupcake.

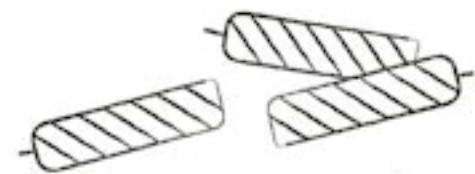

# Kawaii pear

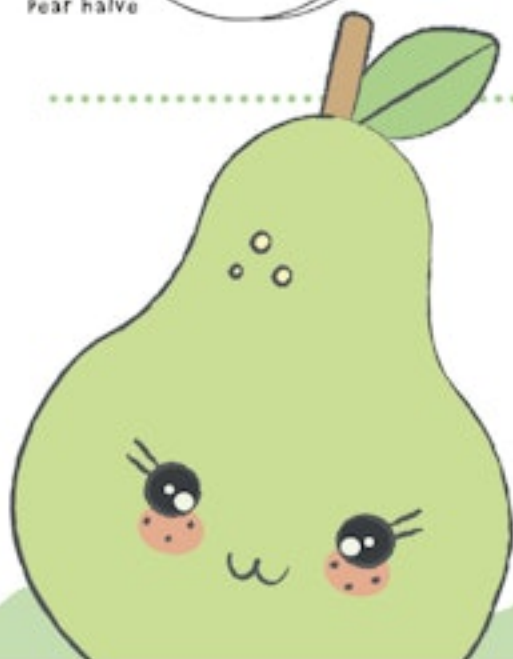
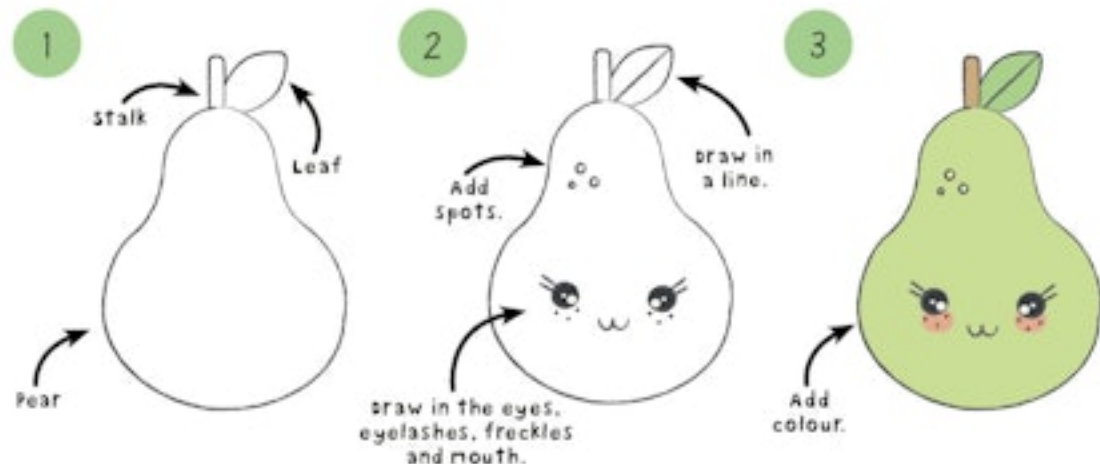

Why not draw your kawaii pear hanging from a tree?

Draw your own kawaii pear. →





# Kawaii coffee

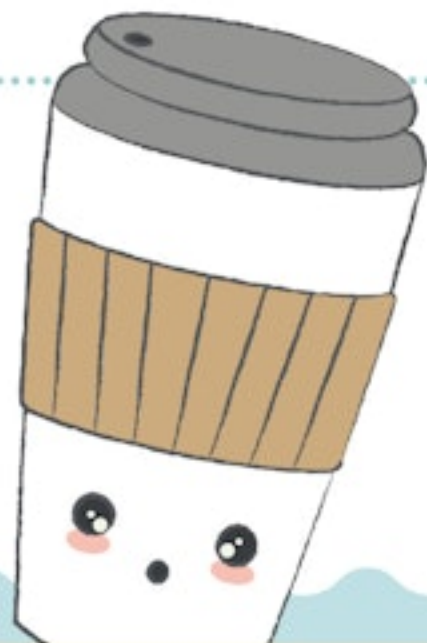
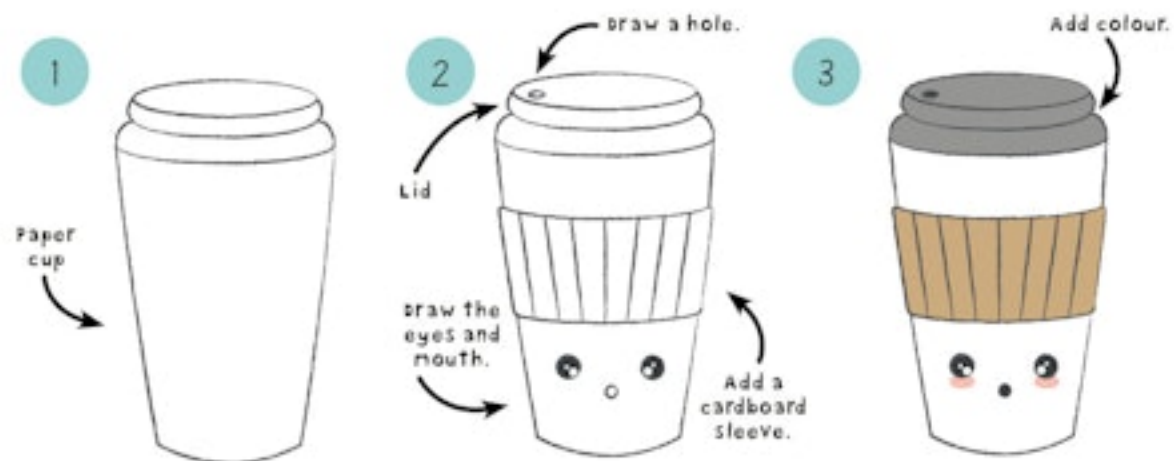

52

Why not draw your kawaii coffee cup on top of a coffee shop counter?

draw your own kawaii coffee.



53

# Kawaii popcorn

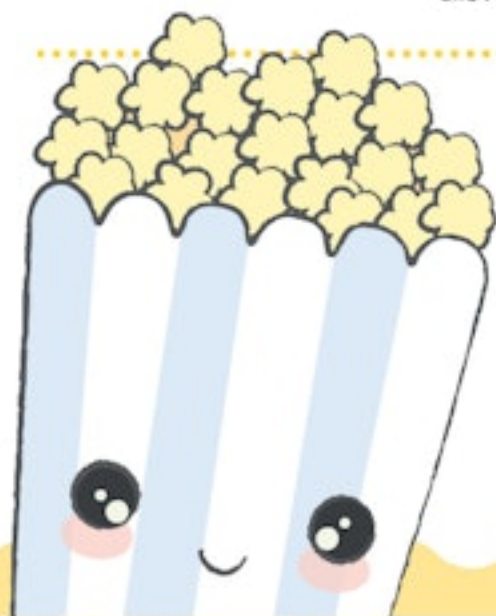
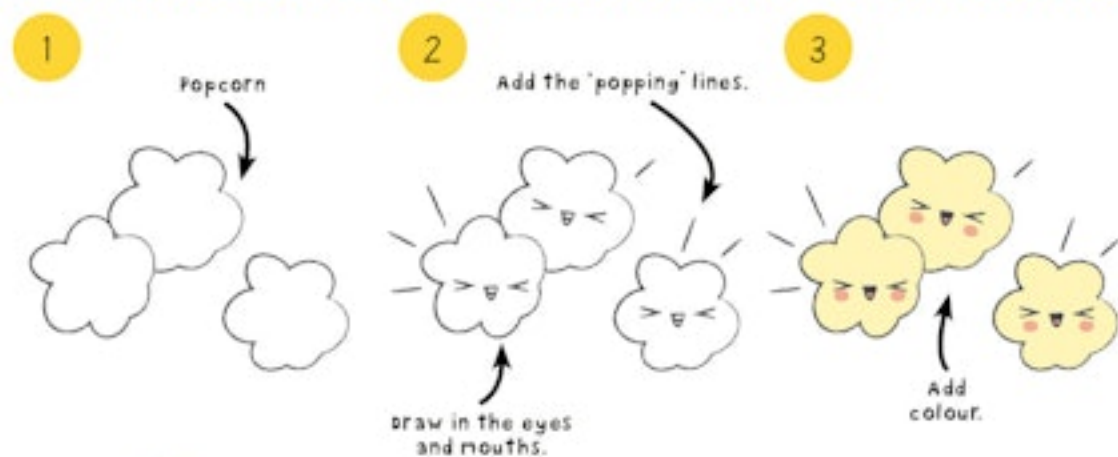
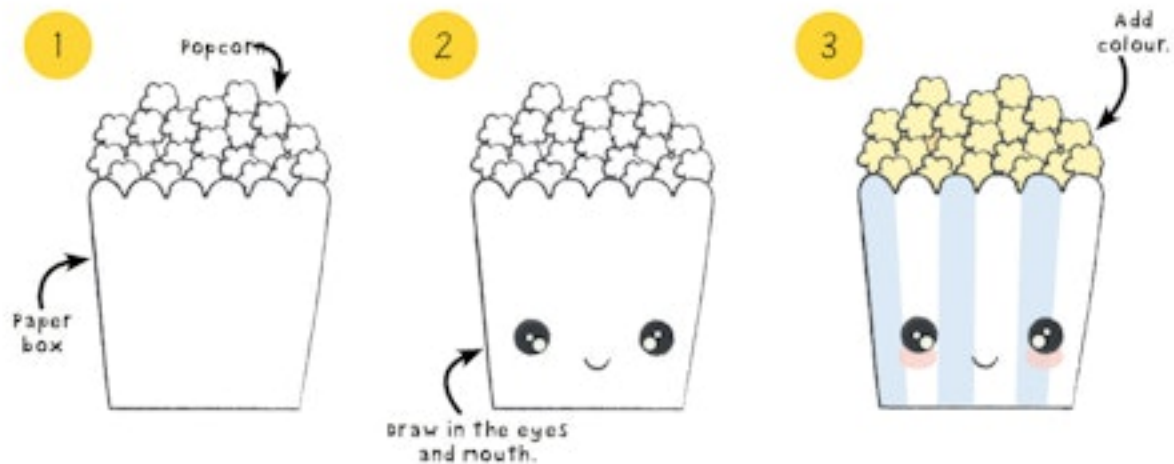

Why not draw a kawaii boy holding your box of kawaii popcorn?

Draw your own kawaii popcorn.

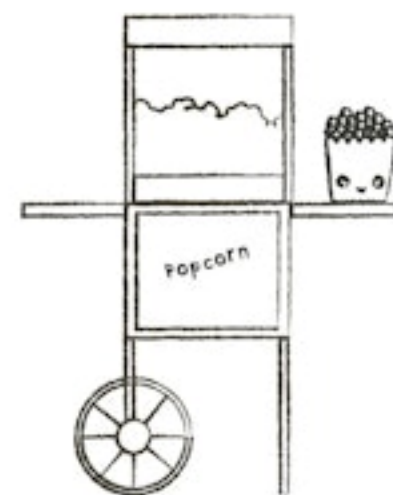

# Kawaii egg

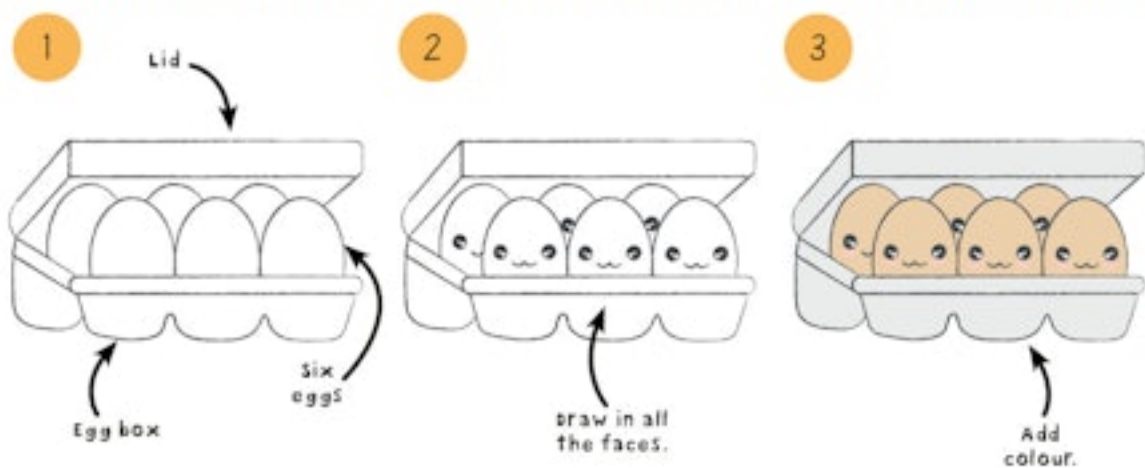
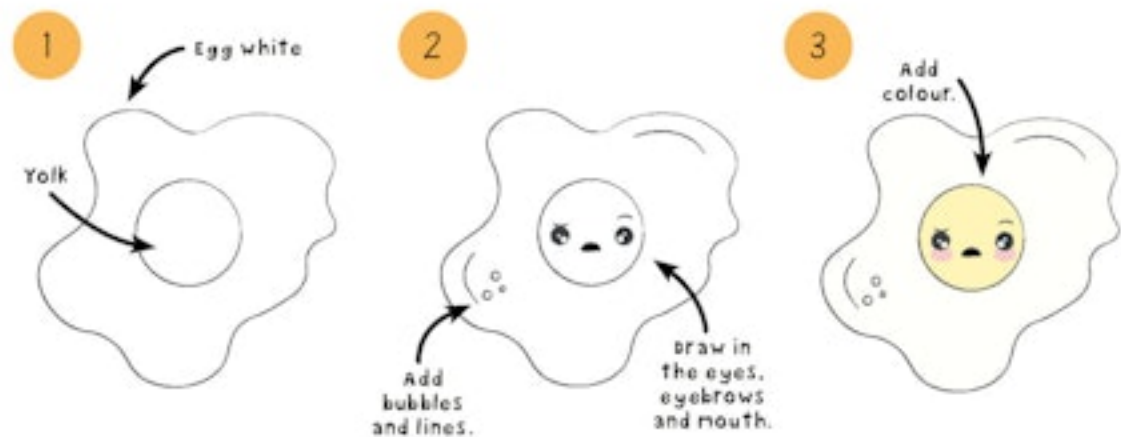

56

Why not draw some kawaii eggs sitting in a frying pan?

draw your own kawaii egg.



57



# Kawaii bread

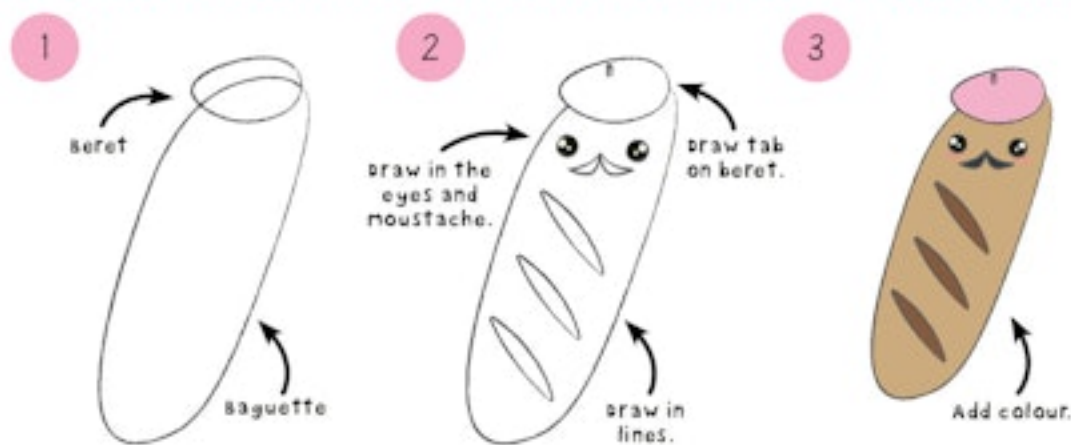
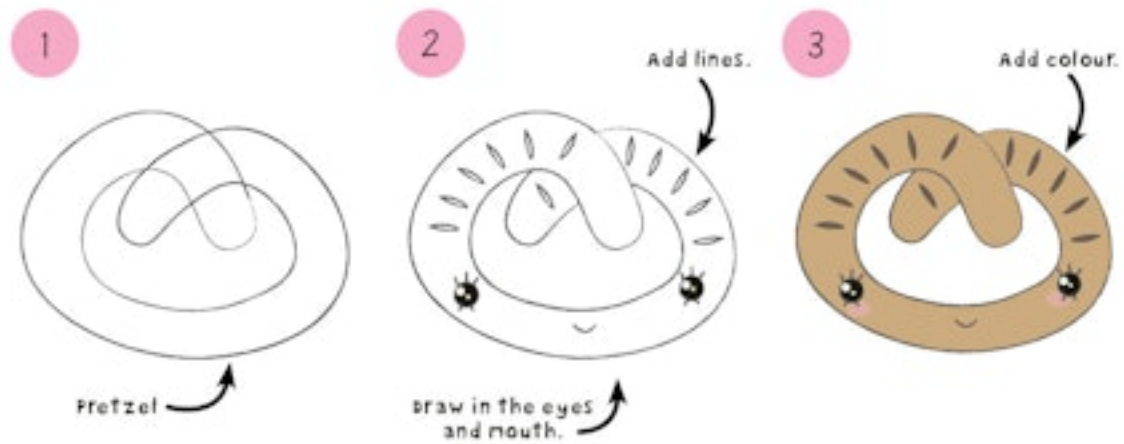

58

Why not draw your kawaii bread in a baker's window?

draw your own kawaii bread.

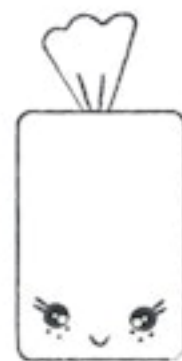

59

# Kawaii sweets

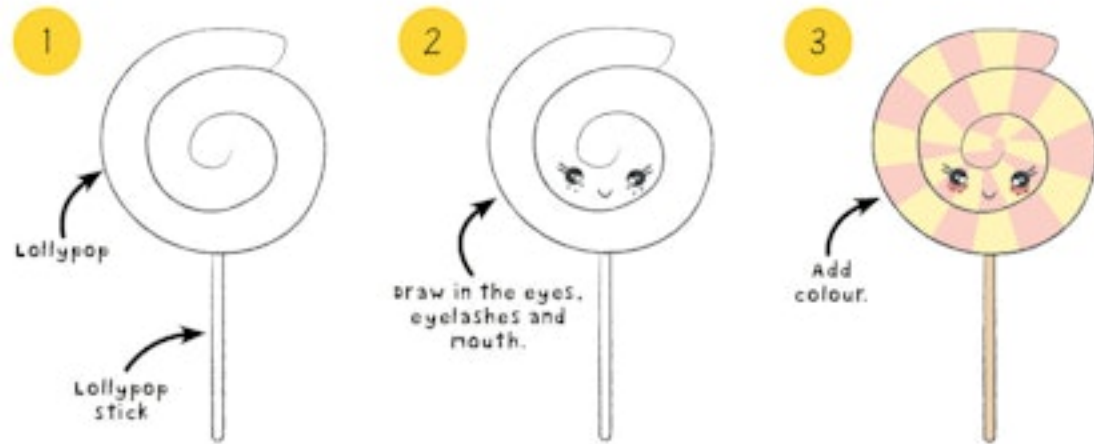

Why not draw your kawaii sweets in a sweet shop window?

draw your own kawaii sweets.



# Kawaii milk

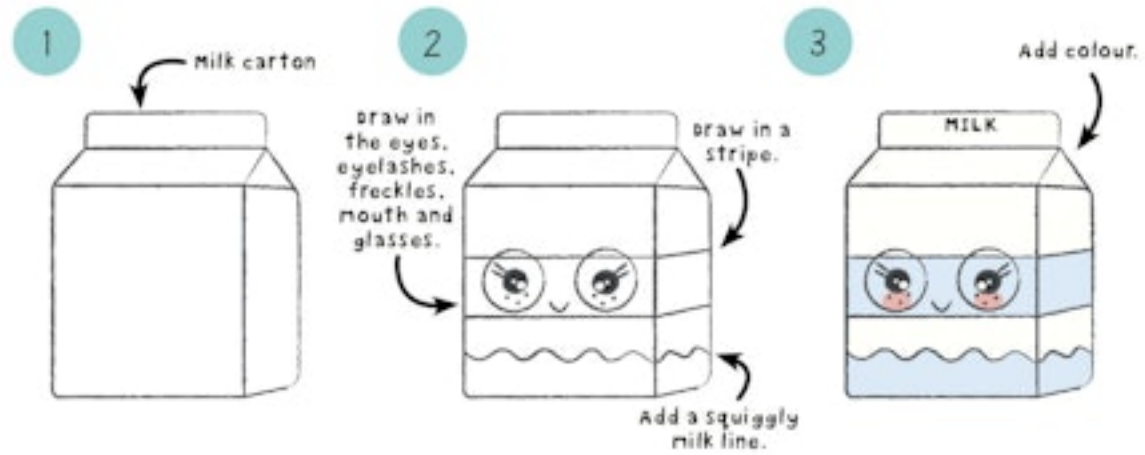

Why not draw a line of kawaii milk cartons in a supermarket fridge?

62

draw your own kawaii milk.



63



# Glossary

**Floret** The tree-like parts that branch off from the stem of the broccoli.

**Pastel** Shades of colour that are soft and gentle. Pastel colours are made with pastel crayons.

**Pretzel** A type of pastry where the dough has been tied into a knot before baking.

**Ramen** A Japanese dish consisting of wheat noodles in a meat or fish-based broth.

**Sushi** A Japanese dish that is made from rice and seafood or vegetables.

**Taco** A Mexican dish consisting of a wheat tortilla with a filling, usually meat-based.

# Index

A  
accessories 10

E  
expressions 12–13,  
20

M  
materials 6  
motion lines 9

P  
pastels 9  
pretzel 58  
proportions 8

R  
ramen 22–23

S  
sketchbook 7  
stickers 7  
sushi 16–17

T  
taco 28–29